

*JP*

## *JP-Electric Retract control V2 Instruction*

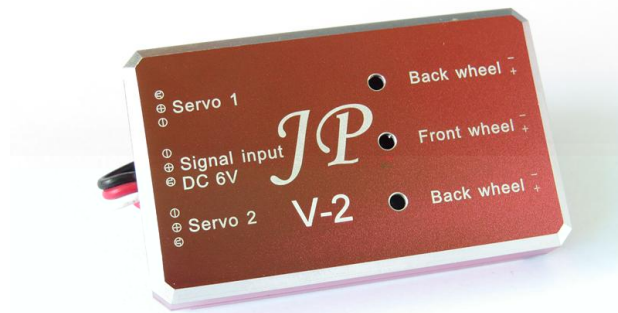

Dear customer, congratulations on the purchase of your new electric retract controller system. A new generation of V2 upgrade version of the retract control system and release doors closed system seamlessly into an organic whole. The difference of retract control system between V2 and V1 is the doors opening and closing. V2 is designed to be multiple activation patterns that is in order to improve the accuracy when it operation. The system will automatically activate the door system after three set of retracts connected on the controller (The system will not able to activate the door system If one of three retract unconnected on the controller. The system automatically identify to abandon the use of port mode at that condition, but other retracts are not effect).



1

### **Electric retract control operating principle:**

In the normal service condition,

**Turn on** the retract switch then the control system will activated the retraction system to **open** after checks the door fully open by Auto. The doors will close after the retract are open.

**Turn off** the retract switch then the control system will activated the retraction system to **close** after

checks the doors fully open by Auto. The doors will close again after the retract are close.

Start the Retract channel → Gear door Open → Retract Down → Gear door Close → Shuttled down Retract channel → Gear door Open → Retract Up → Gear door Close

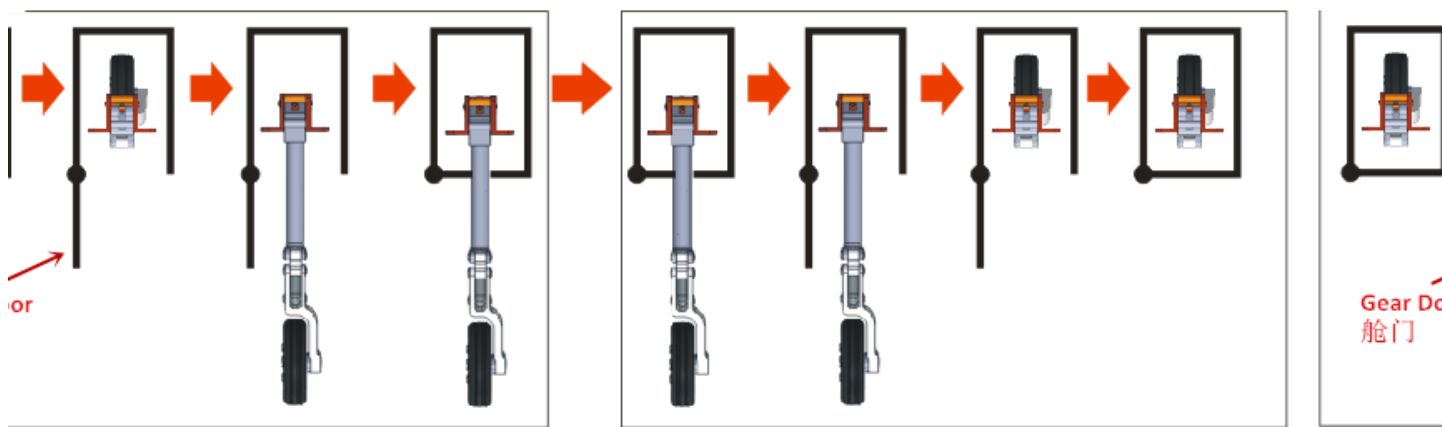

(1)

## Wiring diagram

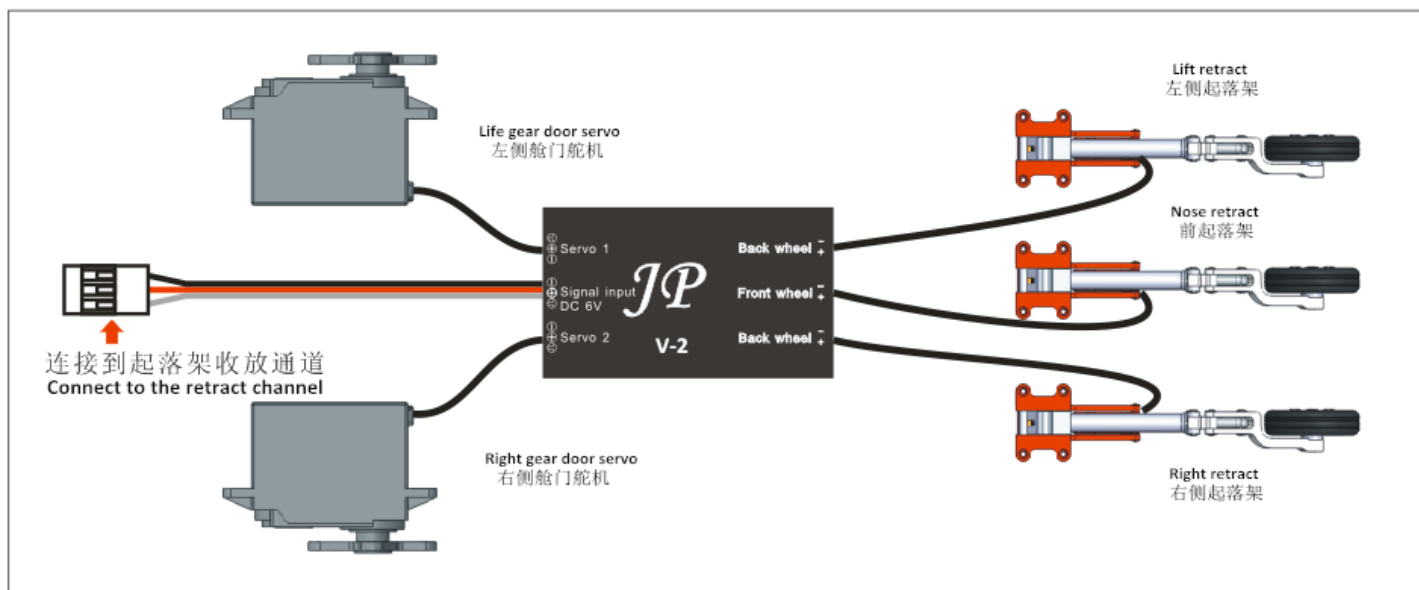

2

## Retracts installation, operation, and maintenance

### Installation:

Installation is simple. The Retracts have a stander clamping, and its installation is similar to any standard retract. An advantage of the electric retract, is that installations of complex valves and air circuits are unnecessary. The Retracts are supplied with long enough cable which is directly connected to the control unit. If the cable is not long enough, it can be extended with the correct polarity. Is advisable prolong just the necessary length to avoid voltage drops.

If you want to assemble a set of retract and its door alone, you may need to use wire as (2) to let the controller activate the door function (Retract controller design with automatic cut off protection function, so the line as (2) will not lead to a panel failure or burned)

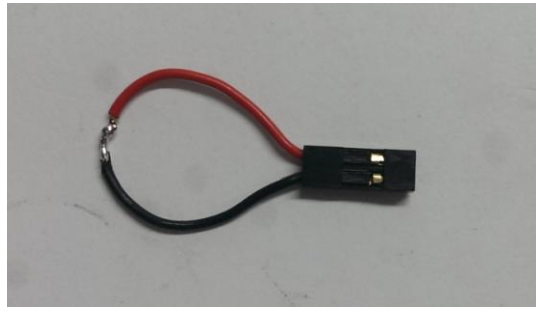

(2)

**Operation:**

Retracts must be operated always through JP Retract Control units. **Never operate the retracts with direct battery or with other brands control units.** The best quality of electric retracts. You will notice the

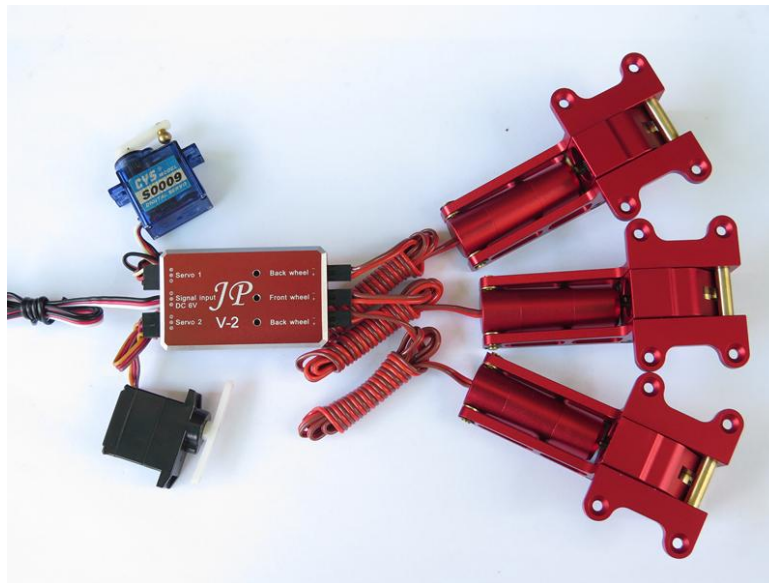

3

**Retracts Trouble shooting**

Problems	Solutions	
The retract don't move.	Check whether the retract controller signal lines connected correctly	The retract controller signal lines connected to the retract channel again
	Check whether the remote control signal is normal	Check the switch channels; Good debugging remote control signal.
	Check whether the remote control retract channel release percentage is set to $\pm 100\%$	Make sure the release percentage is set to $\pm 100\%$
	Check whether the 6V power supply is to run out of electricity	6V battery charged

The gear door don't open	Check whether doors servo signal lines connected correctly.	Please follow the labeled correctly connected in the controller
	Check whether door servo damage	Change the door servo.
	Check whether three units retract are connected to the retract controller	Please connect three units retract to the control system.
The gear door run in wrong direction	Please check the doors servo signal lines connected to the right channel	Change the doors servo signal lines from wrong channel to other one.
Three units retract not work at same direction	Check the retract cable is correct.	Please will reverse running horse cables properly connected to the controller